



CONDITIONAL USE WATER WELL PERMIT APPLICATION
SURFACE WATER IRRIGATION TO GROUNDWATER IRRIGATION

This application is for a permit to construct a conditional use irrigation water well within the Central Platte Natural Resources District Groundwater Management Area

THIS APPLICATION WILL BE RETURNED IF NOT TOTALLY COMPLETED

Well Driller:
Address:
Telephone:

NRD USE ONLY
PERMIT # CPSR
REG #

1. Name
Address
Telephone
2. Surface Water Provider:
A copy of surface water contract may be required

The box below represents one square mile (section). Indicate with an "X" the proposed location of the well. Indicate the location of the lands to be irrigated.

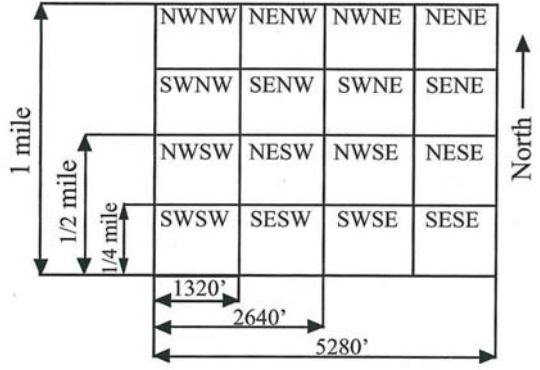

3. Specifications of Intended Well and Pump:
Approximate date construction will begin.
Pump column diameter: inches
Estimated total well depth: feet.
Estimated pumping capacity: gallons per minute
Well casing diameter: inches.
In what formation will screen be placed:
Upper Lower Both
Expected well log, if known.

The _____ (North/South) section line and _____ feet from the _____ (East/West) section line.
5. How many acres will be irrigated?
6. Is all the land currently irrigated? Yes No
If yes, with: Groundwater - Number of Acres
Surface water - Number of Acres

Provide a copy of test drilling report, if available.
4. Identify Location of Proposed Well:
County Township North,
Range West, Section
GPS Reading: (If Available)
Latitude
Longitude

7. Are you increasing or decreasing (circle one) the irrigated acres? Yes No
If yes, how many acres?
SEE PERMIT RESTRICTIONS ON BACK
BACK PAGE ALSO NEEDS TO BE READ & SIGNED

I certify that I am familiar with the information in this application, and that to the best of my knowledge and belief such information is true, complete and accurate.
Date Signature of Applicant
Date Approved Signature of NRD Representative
ENCLOSE: \$50.00 FILING FEE

Conditional Use Permit – Surface Water to Ground Water: This permit is approved with the understanding that the landowner will agree and abide by the following conditions:

1. This water well will be used only when the surface water supply is exhausted and the landowner will provide verification that the surface water is not available.
2. The landowner will provide verification that he/she has maintained the surface water right and will continue to maintain the surface water right in the future.
3. This water well will be used to irrigate lands already irrigated with surface water and that the irrigated acres will not exceed the acres currently irrigated.
4. If it is later determined that offsets have to be made because of any depletions to the river caused by the well that was put in under the variance, whatever offsets have to be made will be the well owner's responsibility to make.
5. Other: _____

The Rules and Regulations of the Temporary Suspension of Groundwater Wells and the above Conditional Use Permit will be enforced by the District through the use of cease and desist orders issued in Accordance with the Rules and Regulations for the enforcement of the Groundwater Management Plan adopted July 23, 1987 and subsequently amended. In accordance with Neb. Rev. Stat § 46-656.10 (cum.supp. 2003), any person who violates a cease and desist order issued by the district shall be subject to a civil penalty of not less than one thousand dollars and not more than five thousand dollars for each day an intentional violation occurs.

I have read and understand that in order to obtain this well permit, drill the conditional use well, and use the conditional use well, I must comply with Central Platte Natural Resources District's Rules and Regulations of the Temporary Suspension of Groundwater Wells, which includes the conditions stated above.

Landowner Signature

This Permit is not a Variance to expand irrigated acres. No new irrigated acres are allowed in the Central Platte Natural Resources District (District) without offsetting other irrigated acres and getting an approved Variance from the District.

**Required Information for
Conditional Use Permit – Surface Water to Groundwater
Within the
Central Platte Natural Resources District's
Suspension of Well Drilling Areas**

This is a Conditional Use only. It is not for wells that would increase irrigated acres and is specifically to be used for land that is irrigated by surface water. A contractual agreement stipulating the amount and location of acres will be required.

Please provide the following:

- ✓ **You will need to complete a Water Well Permit Application provided by the Central Platte NRD and pay a fee of \$50.00 (non-refundable).**
- ✓ **You will need to provide information that the land you are requesting to drill an irrigation well on was irrigated in 2003 or before by surface water. This will require a **crop certification aerial photo from the Farm Service Agency (FSA) showing the acres of irrigated and/or non-irrigated cropland and the crop grown**, or County Tax records if you are not in the Farm Program.**
- ✓ **A copy of the contract with Ditch Company, Canal, or Power District that provides surface irrigation water. This contract should show the legal description of the land irrigated and number of acres presently irrigated.**
- ✓ **Other information that may be requested by the NRD.**

The Conditional Use Permit will require that you maintain your present surface water right indefinitely and only use the ground water well when water is not available because of inadequate surface water supply. The Request will specify that you are not increasing the irrigated acres that were not irrigated by the surface water.

Once a request is made and determined by staff that the application provides the data necessary, a hearing date will be set. The applicant will then be notified of the hearing date and will be requested to appear before a subcommittee of the Water Resources Board of the CPNRD. That same subcommittee will then make a recommendation to the full Board of the CPNRD at its regularly scheduled Board meeting. If the Board does not approve the request, the applicant has the option to request a hearing before the full Board.



Central Platte Natural Resources District

Forward this application and the \$50.00 (non-refundable) filing fee to:
Central Platte Natural Resources District 215 N Kaufman Avenue Grand Island NE
68803

Please take the time to fill out the information correctly. The District will return an incomplete or inaccurate application, with 60 days being allowed to return the application. The District shall issue all permits with conditions attached or denied no later than 30 days after receipt of a complete and properly prepared application.

PERMIT RESTRICTIONS

1. A well permit is required prior to construction. The District must approve the permit application prior to starting any well construction activities.
2. This well may not be constructed closer than 600 feet from another landowner's existing registered irrigation well, unless a special spacing permit (Neb. Rev. Stat. § 46-610) has been granted from the Department of Natural Resources. No irrigation well may be constructed closer than 1,000 feet from an existing industrial or municipal well and no industrial or municipal well may be constructed within 1,000 feet of any other existing well, unless a special spacing permit (Neb. Rev. Stat. § 46-653) has been granted from the Department of Natural Resources or if they are owned by the same individual.
3. If it is later determined that offsets have to be made because of any depletions to the river caused by the well that was put in under the variance, whatever offsets have to be made will be the well owner's responsibility to make.
4. This permit does not register the well with the Department of Natural Resources. All wells are required to be registered with the State Department of Natural Resources within 60 days after the well is completed.
5. If the well is not constructed within a one-year period from the date of approval, a new permit is needed.
6. According to Neb. Rev. Stat. § 46-637, water wells may not be drilled within 50 feet of a stream bank without first getting a surface water right for that stream from the Department of Natural Resources.
7. Any person who, on or after August 30, 1981, commences or causes construction of such a well for which the required permit has not been obtained, or who knowingly furnishes false information regarding such permit, shall be guilty of a Class IV misdemeanor. (Neb. Rev. Stat. § 46-602.01)
8. Permits are not required for test holes, temporary dewatering wells (less than 90 days), or wells designed to pump 50 gallons per minute or less. *If possible mark (with a flag) the well site in the field.*

COMMENTS/RESTRICTIONS:
